

RoHS Compliant

| Circuits | Dimensions (mm) | | | |
|----------|-----------------|-------|-------|-------|
| | A | B | C | D |
| 04 | 3.00 | 5.10 | 9.80 | 11.00 |
| 05 | 4.00 | 6.10 | 10.80 | 12.00 |
| 06 | 5.00 | 7.10 | 11.80 | 13.00 |
| 07 | 6.00 | 8.10 | 12.80 | 14.00 |
| 08 | 7.00 | 9.10 | 13.80 | 15.00 |
| 09 | 8.00 | 10.10 | 14.80 | 16.00 |
| 10 | 9.00 | 11.10 | 15.80 | 17.00 |
| 11 | 10.00 | 12.10 | 16.80 | 18.00 |
| 12 | 11.00 | 13.10 | 17.80 | 19.00 |
| 13 | 12.00 | 14.10 | 18.80 | 20.00 |
| 14 | 13.00 | 15.10 | 19.80 | 21.00 |
| 15 | 14.00 | 16.10 | 20.80 | 22.00 |
| 16 | 15.00 | 17.10 | 21.80 | 23.00 |
| 17 | 16.00 | 18.10 | 22.80 | 24.00 |
| 18 | 17.00 | 19.10 | 23.80 | 25.00 |
| 19 | 18.00 | 20.10 | 24.80 | 26.00 |
| 20 | 19.00 | 21.10 | 25.80 | 27.00 |
| 21 | 20.00 | 22.10 | 26.80 | 28.00 |
| 22 | 21.00 | 23.10 | 27.80 | 29.00 |
| 23 | 22.00 | 24.10 | 28.80 | 30.00 |
| 24 | 23.00 | 25.10 | 29.80 | 31.00 |
| 25 | 24.00 | 26.10 | 30.80 | 32.00 |
| 26 | 25.00 | 27.10 | 31.80 | 33.00 |
| 27 | 26.00 | 28.10 | 32.80 | 34.00 |
| 28 | 27.00 | 29.10 | 33.80 | 35.00 |
| 29 | 28.00 | 30.10 | 34.80 | 36.00 |
| 30 | 29.00 | 31.10 | 35.80 | 37.00 |
| 31 | 30.00 | 32.10 | 36.80 | 38.00 |
| 32 | 31.00 | 33.10 | 37.80 | 39.00 |
| 33 | 32.00 | 34.10 | 38.80 | 40.00 |
| 34 | 33.00 | 35.10 | 39.80 | 41.00 |
| 35 | 34.00 | 36.10 | 40.80 | 42.00 |
| 36 | 35.00 | 37.10 | 41.80 | 43.00 |
| 37 | 36.00 | 38.10 | 42.80 | 44.00 |
| 38 | 37.00 | 39.10 | 43.80 | 45.00 |
| 39 | 38.00 | 40.10 | 44.80 | 46.00 |
| 40 | 39.00 | 41.10 | 45.80 | 47.00 |

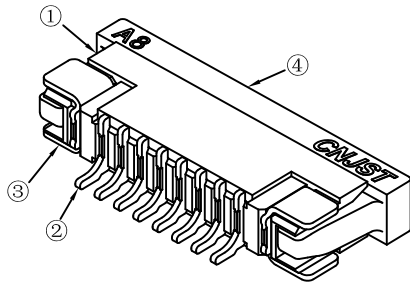
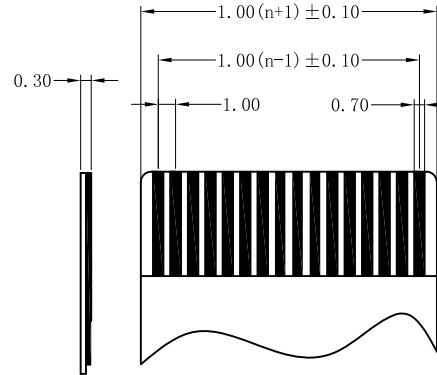
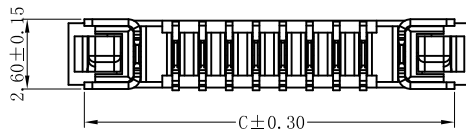
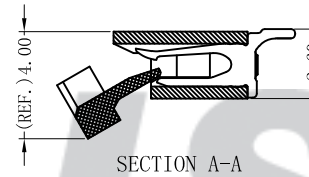
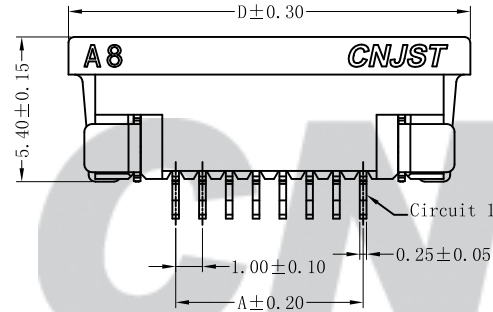
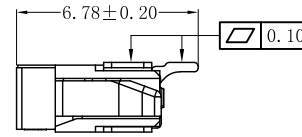
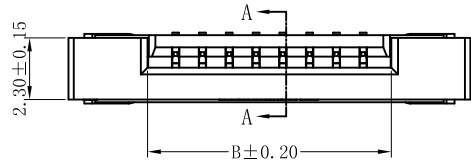

SPECIFICATION

- 1 Contact resistance: $\leq 50m\Omega$
- 2 Insulation resistance: $\geq 500M\Omega$
- 3 Rated voltage: 50 V AC DC
- 4 Rated current: 0.5 A AC DC
- 5 Withstand Voltage: 500V AC/minute
- 6 Temperature Range: $-25^{\circ}C \sim +85^{\circ}C$

ORDER INFORMATION:

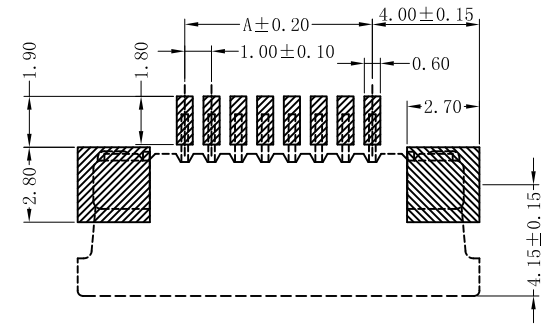
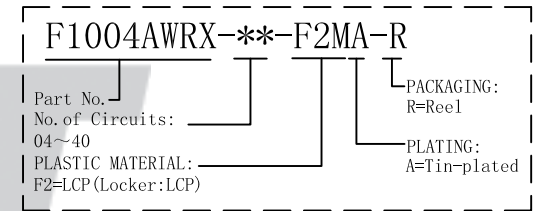

Accommodated FFC/FPC (COMPONENT SIDE)

SUGGESTED PCB LAYOUT (COMPONENT SIDE)

专利产品

| NO. | DESCRIPTION | QTY | MATERIAL | PLATING/COLOR |
|-----|-------------|------|-----------------|---------------|
| ④ | Locker | 1 | LCP (UL94V-0) | Black |
| ③ | Solder Tab | 2 | Phosphor Bronze | Tin-plated |
| ② | Contacts | 4~40 | Phosphor Bronze | Tin-plated |
| ① | Insulator | 1 | LCP (UL94V-0) | Nature |

| Tolerance |
|--------------|
| X.X ± 0.30 |
| X.XX ± 0.20 |
| X.XXX ± 0.10 |
| Angle ± 3.0° |
| UNIT: mm |

| | |
|--|---------------|
| CNJST 捷仕泰企业 | |
| Model No.: F1004AWRX-**-F2MA-R | |
| Model Name: 1.00mm SMT Downside FFC/FPC Connectors | |
| | SCALE: FULL |
| | REVISION: C/0 |

| |
|--------------------------|
| Drawn: 李浩然 2022.11.03 |
| Checked: 吴丹平 |
| Approved: 林旭芝 |
| DWG NO.: CNJST/GCCP-0228 |

| REV. | DATE | DESCRIPTION | APPD. |
|------|------------|-------------|-------|
| C/0 | 2022.11.03 | 更新模板 | 李浩然 |
| B/0 | 2018.08.22 | NEW RELEASE | |